

# EZYSKINZ ASSEMBLY INSTRUCTIONS

## Setting up your EzySkinz Display

1

When you first receive your EzySkinz display, you must ensure that you have received all the parts necessary for you to erect your display:

- 1 x carry bag
- 2 Tall Poles made of 3 stringed pieces
- 2 Corner brackets (Round or Square)
- 1 x 250mm wide metal base with handle
- 1 spring loaded bottom pole
- 1 centre pole
- 1 Top Pole
- 1 x fabric EzySkinz



2

Take each of the poles out of the bag. Each pole is set to fit into one another and are all numbered for your ease of assembly. Insert centre pole inside each hole centre in the side frames and insert spring loaded base pole into side frame.

When joining the poles together, ensure that you push all the buttons through and into the holes, making sure they are all clicking in place and secured.

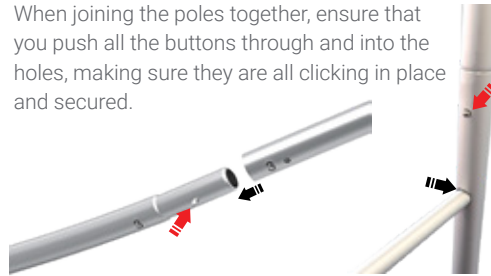

3

Your frame is now complete. and all is assembled except for the metal base. You now need to slip the EzySkinz over the frame by slowly slipping it on, both sides a little bit at a time. Slip it over until it reaches the bottom of the frame. Your frame is now complete. You need to slip the fabric over the frame by slowly slipping it on, both sides a little bit at a time. Slip it over until it reaches the bottom of the frame. Do up the zipper and you are ready to put your EzySkinz on your base



4

Now that you have everything assembled, you are ready to mount your framed EzySkinz onto the 250mm black base. Simply slide your frame onto the two tube fitting and lock the tab in! You're ready to go!

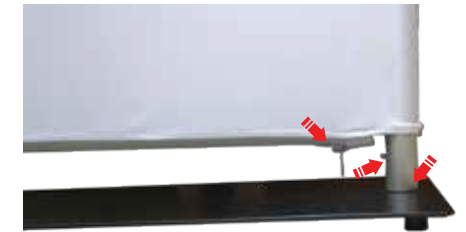

5

Your EzySkinz Display is now assembled. Enjoy using your EzySkinz.

We do recommend you read the instructions on how to Care for your EzySkinz in order to get the most out of your investment over time.



6

## Caring for your EzySkinz

### Cleaning

If your EzySkinz is starting to get dusty or dirty, you can wash it or dry clean it.

For Dry cleaning, simply take it to your agent, however if you are going to wash it yourself, simply turn your EzySkinz inside out and put it into the washing machine on a gentle cold wash with only half the detergent you would normally use and a normal amount of softener.

**Do not** tumble dry, simply hang it up on the cloth line and wait for it to be completely dry before packing it up to avoid any mildew or damage.

### Maintenance

To ensure your Media Wall lasts as long as possible, we recommend basic steps you would need to take.

- 1- Carefully follow the instructions above when putting your media wall together
- 2- When packing away, make sure you keep all the parts together in the bag.
- 3- The bag provided is not made to stand in as packaging for sending via courier. Package carefully in a box.